

# THE SIDEWINDER

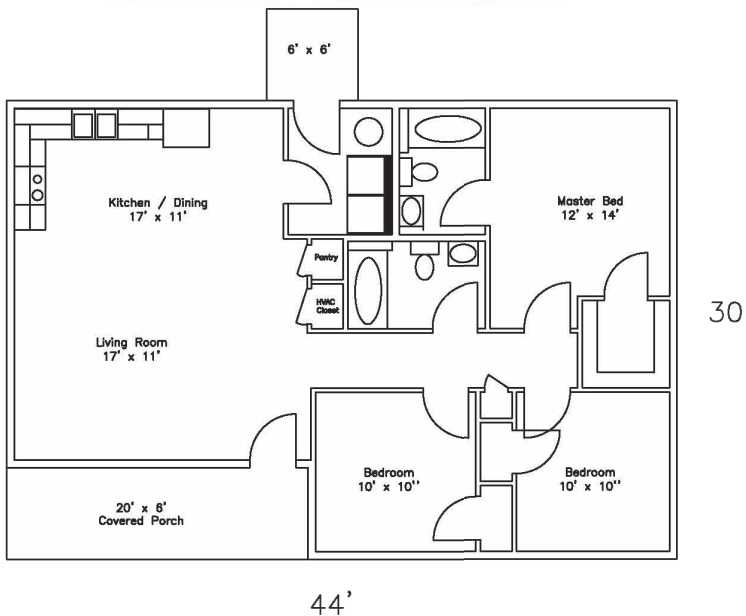

## ABOUT THE DESIGN

The Sidewinder has an open floor plan living space with a spacious Great Room as well as a spacious Master Bedroom. This plan features a large walk-in closet in the Master Bedroom, a linen closet, and a pantry – giving ample space for storage. The home also features a mud room off the back entrance.



## ABOUT THE SIDEWINDER

### GENERAL

- 1,200 sq. ft.
- 3 Bed, 2 Bath
- 6' x 19' Covered Front Porch
- 6' x 6' Back Stoop

### FEATURES

- Rooftop Solar Panels
- Appliances Included (stove, microhood, fridge, dishwasher, washer & dryer)
- Hardie Board Siding
- Vinyl Plank Flooring
- Laminate Countertops
- Light Fixtures & 1 Ceiling Fan
- White Vinyl Porch Railings
- One Tub/Shower Combo & One Step-In Shower

### HIGHLIGHTS

- Large, Open Great Room
- Mud Room with Separate Entrance
- Ample Closet Space
- 2 Full Baths